

13/30

HERITAGE TRACTOR
CODE 131F

INSTRUCTION BOOK

Code **Serial No.**
131F **290000001**

Issue 11/2008



**CAUTION: Read and
follow all instructions.**

Part No. 111-2912 (Rev. A)

1742389
Revision B
TP10006226

Table of Contents

International Pictorials	4
Identification Numbers	5
Limited Warranty	6
Owner's Information	7
Safe Operation Practices	8
Assembly	10
Install the Front Wheels	10
Install the Seat	10
Assemble the Steering Wheel	10
Assemble the Grass Bag	11
Mount the Grass Bag	11
Assemble the Rear Deflector	12
Maintenance Free Battery	12
Charge the Battery	13
Install the Battery Cables	13
Check the Tires	13
Check the Level of the Mower Housing	13
Prepare the Engine	13
Operation	14
Location of Controls	14
Use the Throttle Control	14
Use the Blade Rotation Control	14
Use the Shift Lever	14
Use the Parking Brake	15
Change the Cutting Height	15
Stop the Unit	15
Transport the Unit	15
Operate with the Mower Housing	15
Operate on Hills	16
Use the Grass Bagger	16
Clear the Connector Tube and the Extension Tube	16
Empty the Grass Bagger	16
Before Starting the Engine	17
Check the Oil	17
Add Petrol	17
Start the Engine	17
Mowing and Bagging Tips	18
Maintenance Chart	19
Maintenance	20
General Recommendations	20
Remove and Install the Connector Tube	20
Inspect the Blade	21
Remove and Install the Blade	21
Adjust the Blade Rotation Control	22
Adjust the Shift Lever	23
Check and Adjust the Clutch	23
Check and Adjust the Drive Brake	24
Remove the Battery	24
Charge the Battery	24
Level the Mower Housing	25
Where to Lubricate	25
Check the Tires	26
Replace the Motion Drive Belt	26
Replace the Mower Drive Belt	27
Remove the Mower Housing	27
Replace the Fuse	28
Storage (Over 30 Days)	28
Order Replacement Parts	29
Troubleshooting Chart	30

International Pictorials

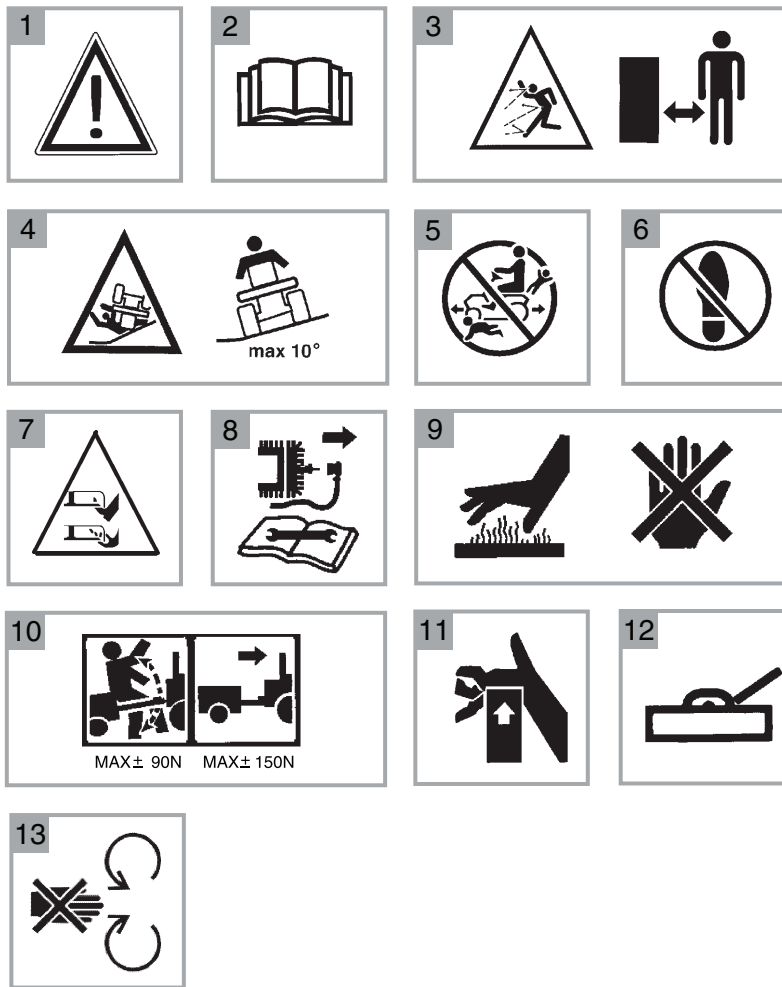

IMPORTANT: The following pictorials are located on your unit or on literature supplied with the product. Before you operate the unit, learn and understand the purpose for each pictorial.

Safety Warning Pictorials

- 1 WARNING
- 2 IMPORTANT: Read owner's manual before operating this machine.
- 3 WARNING: Thrown objects. keep bystanders away. Read user instructions before operating this machine.
- 4 WARNING: Do not use this machine on slopes greater than 10 degrees.
- 5 DANGER: Keep people, especially children away from unit.
- 6 DANGER: No step.
- 7 DANGER: Keep feet and hands away from rotating blade.
- 8 DANGER: Disconnect spark plug wire before servicing unit.
- 9 WARNING: Hot surface.
- 10 WARNING: Use caution when connecting or disconnecting accessories.
- 11 WARNING: Crushed fingers.
- 12 IMPORTANT: Follow instructions in owner's manual to level the deck.
- 13 WARNING: Stay clear of mower blade as long as engine is running.

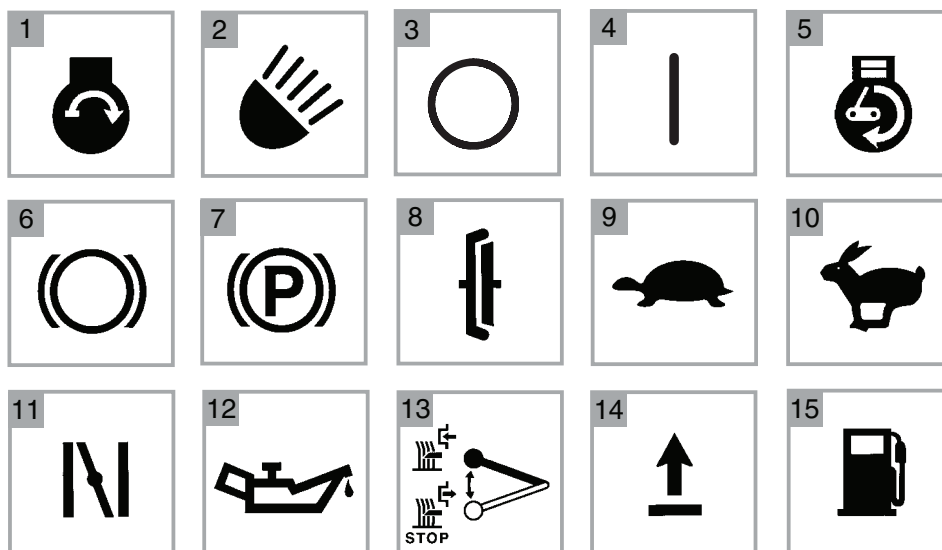

Operation Pictorials

- 1 Engine Start
- 2 Lights
- 3 Engine Stop
- 4 Engine Run
- 5 Engine Run
- 6 Brake
- 7 Parking Brake
- 8 Clutch
- 9 Slow
- 10 Fast
- 11 Choke
- 12 Oil
- 13 Blade Rotation Control
- 14 Raise
- 15 Fuel

Identification Numbers

CE Identification Tag Markings

- A. Manufacturer's Identification Number
- B. Manufacturer's Serial Number
- C. Power Rating in Kilowatts
- D. Maximum Engine Speed in Rotations per Minute
- E. Manufacturer's Name and Address
- F. Year of Manufacture
- G. CE Compliance Logo
- H. Mass of Unit in Kilograms
- I. Guaranteed Sound Power in Decibels

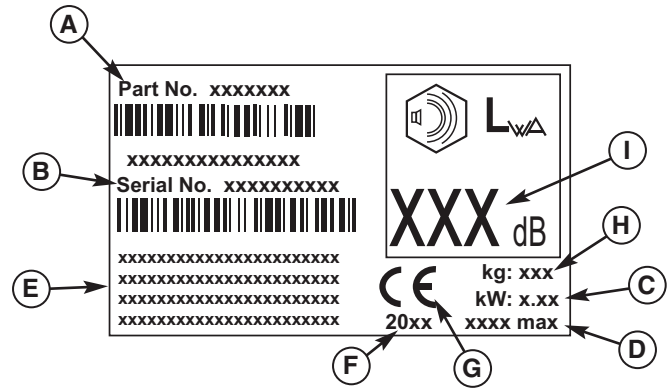

Limited Warranty

Hayter Limited warrants to the original user / purchaser that this unit shall be free from defects in material and workmanship under normal use and service for a period of **three years** from the date of purchase. The manufacturers of the engine and battery pack system (where applicable) furnish their own warranty and services are provided through their authorized network (Refer to "Engine/Battery Pack Warranty Statement"). To qualify for the full benefit of the warranty, the warranty registration card must be returned within 60 days of purchase. Subject to the conditions and exclusions noted in this limited warranty, we shall at our option, repair or replace any warranted part during the applicable period. If you are in doubt or experience any difficulty, please consult a **Hayter** Authorized Service Dealer for clarification.

To qualify for the extended warranty (second and third year) of the three year limited warranty, the machine must have annual services carried out by an Authorized Hayter Service Dealer. These chargeable services should be carried out within 12 and 24 months of the date of purchase.

Excluded from the extended warranty period are those items which are subject to normal wear and tear e.g. tires, wheels, cutterbars, cables, batteries and other consumable wearing parts.

All consumer machines which are fitted with a **genuine** Hayter friction disc as original equipment, before use, are covered by a **Lifetime Warranty** against the engine crankshaft bending. **Note:** friction washers, blade brake units and other such devices are not applicable. Only machines fitted with a genuine Hayter friction disc, which are used in accordance with the recommended operating and maintenance procedures, are covered.

This warranty does not apply to any unit that has been tampered with, altered, misused, abused or used for hire, and will become invalid if non genuine Hayter parts are fitted. This warranty does not cover minor mechanical adjustments unless they are due to defective materials or workmanship. Consult the Owner's Handbook or a Hayter Authorized Service Dealer for assistance when making these adjustments.

A warranty period of 90 days applies to machines used for commercial purposes.

To make a warranty claim, return the unit to a **Hayter** authorized dealer along with proof of purchase stating the machine serial number and date of purchase. The service receipt(s) or this Owner's Handbook with the 1st/2nd year service boxes fully completed, must be produced as proof of entitlement to the extended warranty period. Subject to the conditions and exclusions in this limited warranty, the authorized dealer will, at our option, repair or replace any warranted part within the duration of the warranty period.

This limited warranty gives you specific legal rights and is in addition to any statutory rights to which you may be entitled and your statutory rights are not affected by this warranty. If you need additional information concerning this written warranty, or assistance in obtaining services, please write to:

HAYTER LIMITED, Service Department, Spellbrook, Bishop's Stortford, Hertfordshire CM23 4BU.

1st
Year
Service
Record

2nd
Year
Service
Record

Date
Signed

Date
Signed

Owner's Information

Know Your Product

If you understand the unit and how the unit operates, you will get the best performance. As you read this manual, compare the illustrations to the unit. Learn the location and the function of the controls. To help prevent an accident, follow the operating instructions and the safety rules. Keep this manual for future reference.

WARNING

Look for this symbol to indicate important safety precautions. This symbol indicates: "Attention! Become Alert! Your Safety Is At Risk."

Responsibility of the Owner

WARNING

This cutting machine is capable of amputating hands and feet and throwing objects. Failure to observe the following safety instructions could result in serious injury or death to the operator or bystanders.

The responsibility of the owner is to follow the instructions below.

Safe Operation Practices

For Ride-On (Riding) Rotary Mower Machines

Training

1. Read the instructions carefully. Be familiar with the controls and the proper use of the equipment.
2. Never allow children or people unfamiliar with these instructions to use the mower. Local regulations may restrict the age of the operator.
3. Never mow while people, especially children, or pets are nearby.
4. Keep in mind that the operator or user is responsible for accidents or hazards occurring to other people or their property.
5. Do not carry passengers.
6. All drivers should seek and obtain professional and practical instruction. Such instruction should emphasize:
 - a. the need for care and concentration when working with ride-on machines;
 - b. control of a ride-on machine sliding on a slope will not be regained by the application of the brake. The main reasons for loss of control are:
 - insufficient wheel grip;
 - being driven too fast;
 - inadequate braking
 - the type of machine is unsuitable for its task;
 - lack of awareness of the effect of ground conditions, especially slopes;
 - incorrect hitching and load distribution.

Preparation

1. While mowing, always wear substantial footwear and long trousers. Do not operate the equipment when barefoot or wearing open sandals.
2. Thoroughly inspect the area where the equipment will be used and remove all objects which may be thrown by the machine.
3. **WARNING-Petrol is highly flammable.**
 - a. Store fuel in containers specifically designed for this purpose.
 - b. Refuel outdoors only and do not smoke while refuelling.
 - c. Add fuel before starting the engine. Never remove the cap of the fuel tank or add petrol while the engine is running or when the engine is hot.
 - d. If petrol is spilled, do not attempt to start the engine but move the machine away from the area of spillage and avoid creating any source of ignition until petrol vapours have dissipated
 - e. Replace all fuel tanks and container caps securely.
4. Replace faulty silencers.
5. Before using, always visually inspect to see that the blades, blade bolts and cutter assembly are not worn or damaged. Replace worn or damaged blades and bolts in sets to preserve balance.
6. On multi-blade machines, take care as rotating one blade can cause other blades to rotate.

Operation

1. Do not operate the engine in a confined space where dangerous carbon monoxide fumes can collect.
2. Mow only in daylight or in good artificial light.
3. Before attempting to start the engine, disengage all blade attachment clutches and shift into neutral.
4. Do not use on slopes of more than 10 degrees.
5. Remember there is no such thing as a "safe" slope. Travel on grass slopes requires particular care. To guard against overturning:
 - a. do not stop or start suddenly when going up or downhill;
 - b. engage clutch slowly, always keep machine in gear, especially when travelling downhill;
 - c. machine speeds should be kept low on slopes and during tight turns;
 - d. stay alert for humps and hollows and other hidden hazards;
 - e. never mow across the face of the slope, unless the mower is designed for this purpose.
6. Use care when pulling loads or using heavy equipment.
 - a. Use only approved drawbar hitch points.
 - b. Limit loads to those you can safely control.
 - c. Do not turn sharply. Use care when reversing.
 - d. Use counterweight(s) or wheel weights when suggested in the Instruction Book.
7. Watch out for traffic when crossing or near roadways.
8. Stop the blades rotating before crossing surfaces other than grass.

Safe Operation Practices

9. When using any attachments, never direct discharge of material toward bystanders nor allow anyone near the machine while in operation.
10. Never operate the mower with defective guards or shields, or without safety protective devices in place.
11. Do not change the engine governor settings or overspeed the engine. Operating an engine at excessive speed may increase the hazard of personal injury.
12. Before leaving the operator's position
 - a. disengage the power take-off and lower the attachments;
 - b. change into neutral and set the parking brake;
 - c. stop the engine and remove the key.
13. Disengage drive to attachments, stop the engine, and disconnect the spark plug wire(s) or remove the ignition key
 - a. before cleaning blockages or unclogging chute;
 - b. before checking, cleaning or working on the mower;
 - c. after striking a foreign object. Inspect the mower for damage and make repairs before restarting and operating the equipment;
 - d. if the machine starts to vibrate abnormally (check immediately).
14. Disengage drive to attachments when transporting or not in use.
15. Stop the engine and disengage drive to attachment
 - a. before refuelling;
 - b. before removing the grass catcher;
 - c. before making height adjustment unless adjustment can be made from the operator's position.

16. Reduce the throttle setting during engine run-out and, if the engine is provided with a shut-off valve, turn the fuel off at the conclusion of mowing.
17. Before and when backing, look behind and down for small children.
18. Use extra care when approaching blind corners, shrubs, trees or other objects that may obscure vision.

Maintenance and Storage

1. On multi-blade machines, take care as rotating one blade can cause other blades to rotate.
2. When machine will be parked, stored or left unattended, lower the cutting means unless a positive mechanical lock is used.
3. Keep all nuts, bolts, and screws tight to be sure the equipment is in safe working condition.
4. Never store the equipment with petrol in the tank inside a building where fumes may reach an open flame or spark.
5. Allow the engine to cool before storing in any enclosure.
6. To reduce the fire hazard, keep the engine, silencer, battery compartment and petrol storage area free of grass, leaves, or excessive grease.
7. Check the grass catcher frequently for wear or deterioration.
8. Replace worn or damaged parts for safety.
9. If the fuel tank has to be drained, this should be done outdoors.

Assembly

All fasteners are in the parts bag. Do not discard any parts or material until the unit is assembled.

NOTE: In this Instruction Book, left and right describe the location of a part with the operator on the seat.

Install the Front Wheels

NOTE: Use a piece of wood about 4 feet (1.25 meters) long to raise the front of the tractor. If a piece of wood cannot be found, get another person to help lift the tractor. Be careful, do not let the tractor fall.

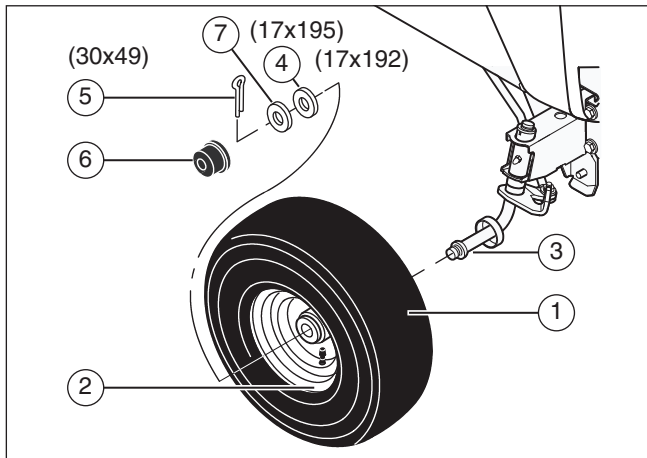

Figure 1

1. Raise the front of the tractor. Set a support (block of wood) under the tractor.
2. Slide the front wheel (1) on the spindle (3) (see **Figure 1**). Install the front wheel so the tire is offset away from the tractor.
3. Fasten each front wheel with washer (4), washer (7), and cotter pin (5). Bend the ends of the cotter pin apart to keep the front wheel on the spindle.
4. After the front wheels are installed, lift the tractor from the support. Roll the tractor off of the container.
5. If your tractor has hub caps (6), install the hub caps. Make sure the washers hold the hub caps in place.

Install the Seat

1. Carefully remove the plastic bag from the seat.
2. Align the holes in the seat hinge (2) to the holes in the seat (1) (see **Figure 2**). Fasten the seat to the seat hinge (2) with the fasteners (4) and (5).
3. Check the operating position of the seat (1). If the seat needs to be adjusted, loosen the two wing bolts (5). Slide the seat forward or backward along the seat adjusting holes (3). Tighten the wing bolts.

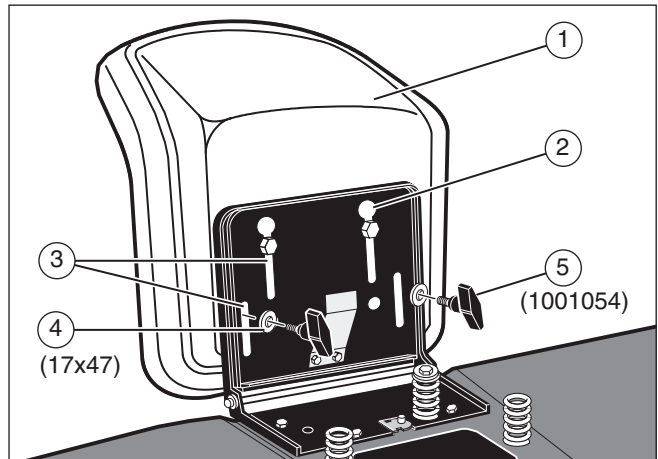

Figure 2

Assemble the Steering Wheel

1. Make sure the front wheels point forward.
2. Slide the cover (3) over the steering post (2) (see **Figure 3**). Make sure the collar of the cover is on top.

NOTE: Before attachment of the steering wheel, make sure that the front wheels point forward and are straight. See **Figure 4** for proper alignment of the steering wheel (1).

3. Slide the steering wheel (1) onto the steering post (2) (see **Figure 3**).
4. Attach the steering wheel to the steering post with screw (4) and washer (6).
5. Attach the cover (3) to the steering wheel.
6. Some models have an optional insert (7) in the parts bag. Attach the insert to the center of the steering wheel.

Assembly

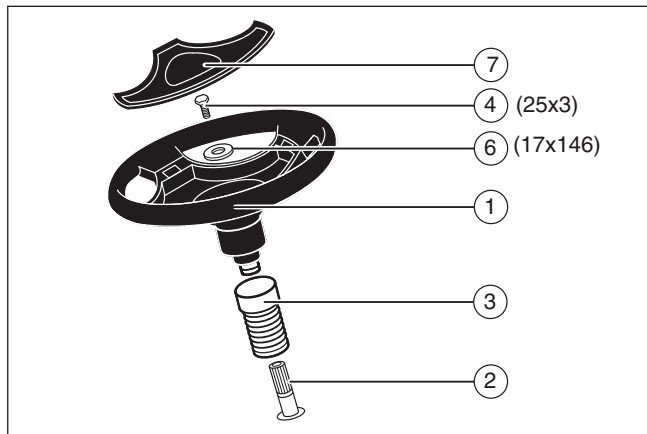

Figure 3

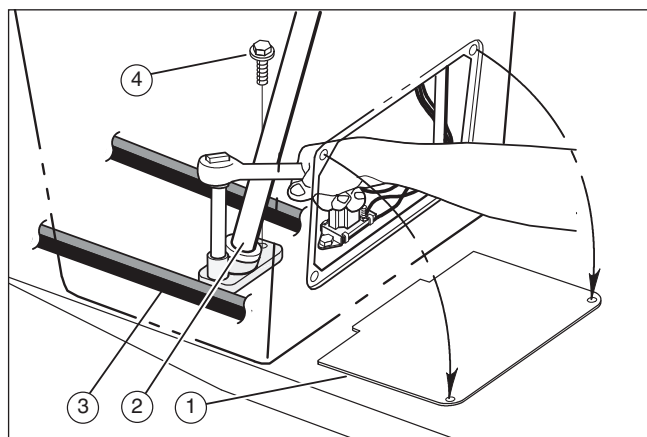

Figure 4

Assemble the Grass Bag

1. Slide the top tube (1) onto the wire frame (2) (see **Figure 5**). Make sure the handles (3) on the top tube and the wire frame are on top.
2. Attach the struts (4) to the INSIDE of the mounting tabs (5) with bolt (6) and nut (7). Make sure the head of bolt is on the outside and nut is locked against the strut.

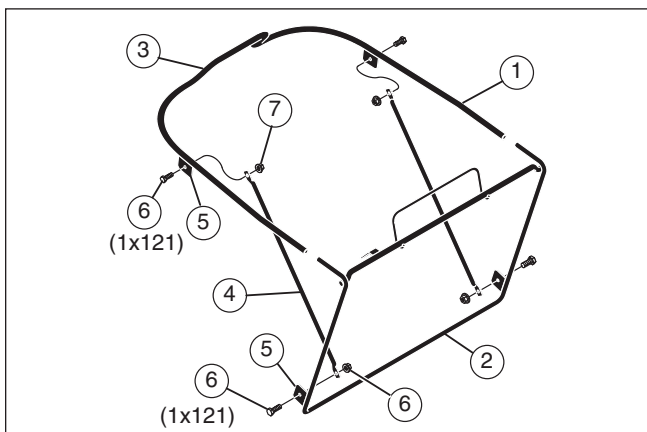

Figure 5

3. Slide the frame assembly (8) into the grass bag (9) (see **Figure 6**). Make sure the Velcro flap (10) is on top.
4. Open the Velcro flap (10) (see **Figure 7**). Slide the handle (3) through the opening and secure the Velcro flap under the handle.
5. Attach the clips (11) to the frame assembly (8).

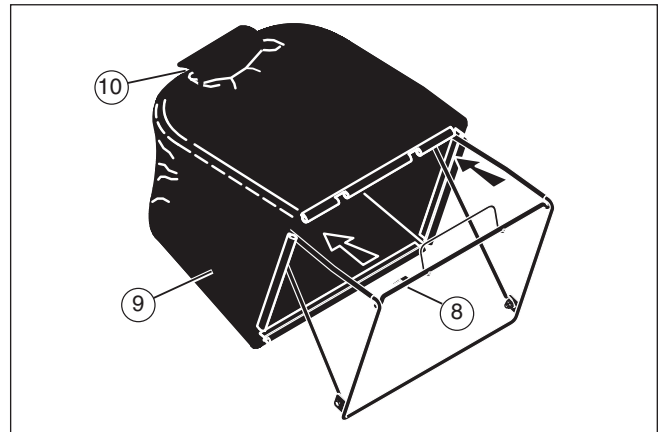

Figure 6

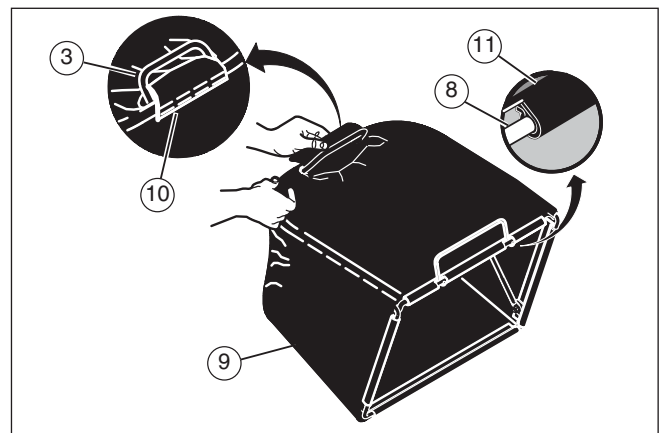

Figure 7

Mount the Grass Bag

1. To lift the grass bag assembly, use the grass bag handles (3) (see **Figure 8**).
2. Raise the rear bagger cover (16) away from the rear plate.
3. Mount the top of the grass bag assembly (12) onto the rear plate hinges (13) (see **Figure 9**).
4. When mounting the top of the grass bag (9), hold the bottom of the grass bag slightly away from the rear plate (14) (see **Figure 8**).
5. Lower the grass bag (9) until the bottom is against the rear plate (see **Figure 10**).

Assembly

6. Push down on the rear handle. A locking spring (15) on the rear plate will secure the bottom of the grass bag assembly (12) (see **Figure 9**).
7. Lower the rear bagger cover (16) until it rests on the grass bagger assembly (see **Figure 10**).

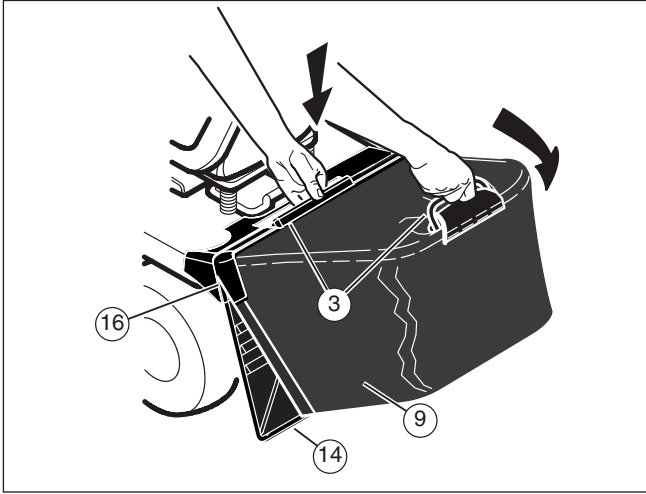

Figure 8

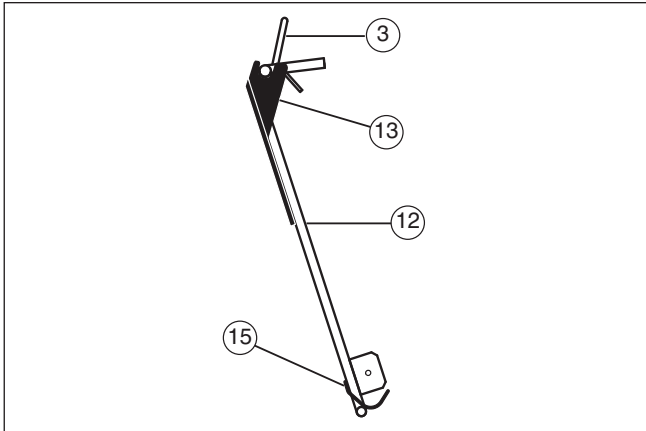

Figure 9

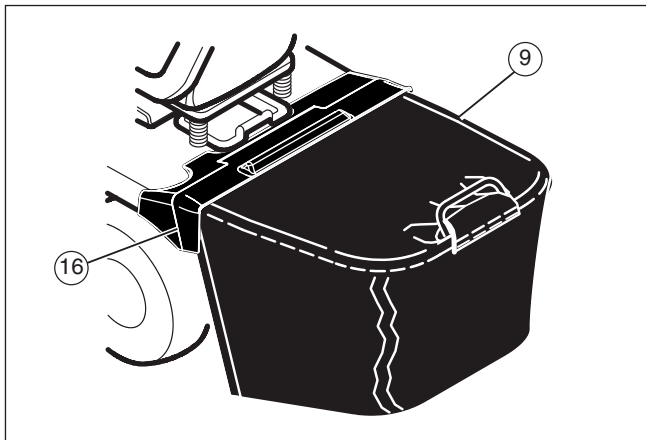

Figure 10

Assemble the Rear Deflector

1. Mount the carriage bolts (1) in the square holes of the rear plate (2) (see **Figure 11**).
2. Attach the retainers (3) to the carriage bolts (1). The retainers (3) will hold the carriage bolts (1) in place.
3. Assemble the rear deflector (4) to the rear plate (2) with the wing nuts (5).

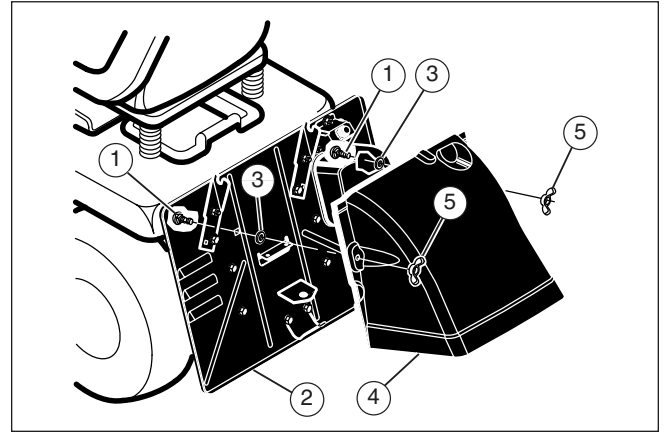

Figure 11

Maintenance Free Battery

IMPORTANT: Before you attach the battery cables to the battery, check the battery date. The battery date tells if the battery must be charged.

1. Check the top of the battery (1) for the location of the battery date (see **Figure 12**).
2. If the battery is put into service before the battery date, the battery cables can be attached without charging the battery. See "Install The Battery Cables".
3. If the battery is put into service after the battery date, the battery must be charged. See "Charge The Battery".

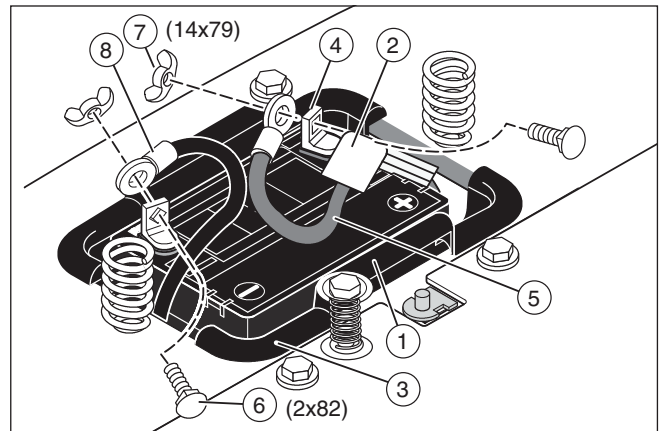

Figure 12

Assembly

Charge the Battery

WARNING

When you charge the battery, do not smoke. Keep the battery away from any sparks. The fumes from the battery acid can cause an explosion.

1. Remove the battery (1) and battery tray (3) (see **Figure 12**).
2. Remove the protective caps from the battery terminals.
3. Use a 12 volt battery charger to charge the battery. Charge at a rate of 6 amps for one hour. If you do not have a battery charger, have an authorized service center charge the battery.
4. Install the battery (1) and battery tray (3). Make sure the positive (+) terminal (4) is on the left side.

Install the Battery Cables

WARNING

To prevent sparks, fasten the red cable to the positive (+) terminal before you connect the black cable.

1. Remove the protective caps from the battery terminals (see **Figure 12**).
2. Slide the terminal cover (2) onto the red cable (5). Fasten the red cable to the positive (+) terminal (4) with the fasteners (6) and (7).
3. Fasten the black cable (8) to the negative (-) terminal with the fasteners (6) and (7).

Check the Tires

NOTE: Actual sustained horsepower will likely be lower due to operating limitations and environmental factors.

Check the air pressure in the tires. Tires with too much air pressure will cause the unit to ride rough. Also, the wrong air pressure will keep the mower housing from cutting level. The correct air pressure is shown on the side of the tires.

Check the Level of the Mower Housing

Make sure the level of cut is still correct. After you mow a short distance, look at the area that was cut. If the mower housing does not cut level, see “Level the Mower Housing”.

Prepare the Engine

NOTE: The engine was shipped from the factory filled with oil. Check the level of the oil. Add oil as needed.

NOTE: The operation of a new engine will sometimes result in a slight amount of smoke. This smoke is caused by paint or oil on or around the muffler. This is normal and only expected during initial operation.

A separate engine manual is also included with the unit. See this engine manual for the manufacturer’s instructions for the type of petrol and oil to use. Before you use the unit, read the information on safety, operation, maintenance, and storage.

WARNING

Follow the engine manufacturer’s instructions for the type of petrol and oil to use. Always use a safety petrol container. Do not smoke when adding petrol to the engine. When inside an enclosure, do not fill with petrol. Before you add petrol, stop the engine. Let the engine cool for several minutes.

Important! Before You Start Mowing

- Check the engine oil.
- Fill the fuel tank with petrol.
- Check the air pressure of the tires.
- Check the level of the mower housing.
- Attach the battery cables.
- Make sure the wire is attached to the spark plug.

Operation

Location of Controls

Blade Rotation Control (1): Use the blade rotation control to start and stop the rotation of the blade (see **Figure 13**).

Clutch/Brake Pedal (2): The pedal has two functions. The first function is a clutch. The second function is a brake.

Headlight Switch (3): The headlight switch is the first part of the ignition switch. To use the lights with the engine running, turn the key to the position for the lights.

Ignition Switch (3): Use the ignition switch to start and stop the engine.

Shift Lever (4): Use the shift lever to change the speed of the unit.

Lift Lever (5): Use the lift lever to change the height of cut.

Parking Brake Lever (6): Use the parking brake lever to engage the brake when you leave the unit.

Throttle Control Lever (7): Use the throttle control lever to increase or decrease the speed of the engine.

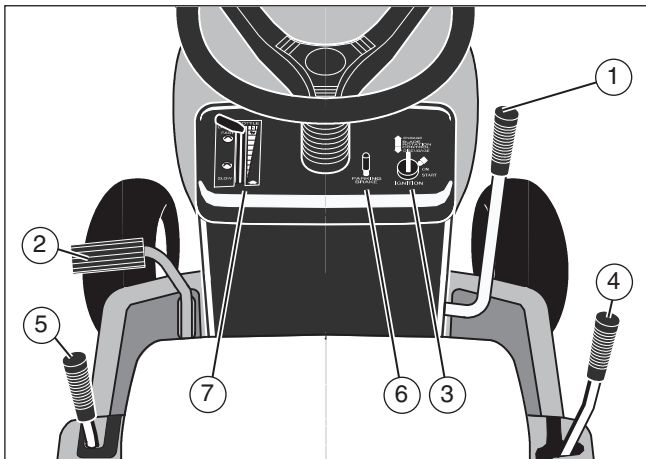

Figure 13

Use the Throttle Control

Use the throttle control (7) to increase or decrease the speed of the engine (see **Figure 13**).

! CAUTION

Always operate the engine with the throttle control in the **FAST** position. If the engine runs for several minutes at slower than the **FAST** position, the engine and transmission will overheat and can be damaged.

1. The **FAST** position is marked with a detent. For normal operation and when using a grass bagger, move the throttle control to the **FAST** position. For maximum charging of the battery and for a cooler running engine, operate the engine in the **FAST** position.

2. For transport and to tow pull behind attachments, move the throttle control to the **SLOW** position.
3. The engine governor is set at the factory for maximum performance. Do not adjust the governor to increase the speed of the engine.

Use the Blade Rotation Control

Use the blade rotation control (1) to engage the blade(s) (see **Figure 13**).

1. Before you start the engine, make sure the blade rotation control (1) is in the **DISENGAGE** position.
2. Move the blade rotation control to the **ENGAGE** position to rotate the blade(s).

NOTE: If the engine stops when you engage the blade(s), the seat switch or the grass bag switch is not activated.

3. Move the blade rotation control to the **DIS-ENGAGE** position to stop the blade(s). Before you leave the operator's position, make sure the blade(s) has stopped rotating.
4. Before you ride the unit across a sidewalk or a road, move the blade rotation control to the **DISENGAGE** position.

! WARNING

Always keep your hands and feet away from the blade, deflector opening, and the mower housing when the engine runs.

Use the Shift Lever

To change the forward speed or the direction of the unit, follow the steps below.

! CAUTION

Before you move the shift lever, completely push the clutch/brake pedal forward to stop the unit. If the unit is not stopped, the gearbox can be damaged.

1. Completely push the clutch/brake pedal (2) forward to stop the unit. Keep your foot on the pedal (see **Figure 13**).
2. Move the throttle control lever (7) to the **SLOW** position.
3. To go forward, move the shift lever (4) to a forward speed setting. To go backward, move the shift lever to reverse.
4. Slowly release the clutch/brake pedal. Do not keep your foot on the pedal.
5. Move the throttle control to the **FAST** position.

Operation

Use the Parking Brake

1. Completely push the clutch/brake pedal (2) forward (see **Figure 13**).
2. Lift the parking brake lever (6).
3. Remove your foot from the clutch/brake pedal and then release the parking brake lever. Make sure the parking brake will hold the unit.
4. To release the parking brake, completely push the clutch/brake pedal forward. The parking brake will automatically release.

WARNING

Before you leave the operator's position, move the shift lever to the neutral (N) position. Set the parking brake. Move the blade rotation control to the DISENGAGE position. Stop the engine and remove the ignition key.

Change the Cutting Height

To change the cutting height, raise or lower the lift lever (5) as follows (see **Figure 13**).

1. Move the lift lever forward to lower the mower housing and back to raise the mower housing.
2. When you ride on a sidewalk or road, move the lift lever to the highest position and move the blade rotation control to the DISENGAGE position.

Stop the Unit

1. Completely push the clutch/brake pedal (2) forward to stop the unit. Keep your foot on the pedal (see **Figure 13**).
2. Move the blade rotation control (1) to the DISENGAGE position.
3. Move the shift lever (4) to the NEUTRAL position.
4. Set the parking brake.

WARNING

Make sure the parking brake will hold the unit.

5. Move the throttle control (7) to the SLOW position.
6. To stop the engine, turn the ignition key (3) to the OFF position. Remove the key.
7. Some models have a fuel shut-off valve (1) located under the fuel tank (see **Figure 14**). If equipped, close the fuel shut-off valve.

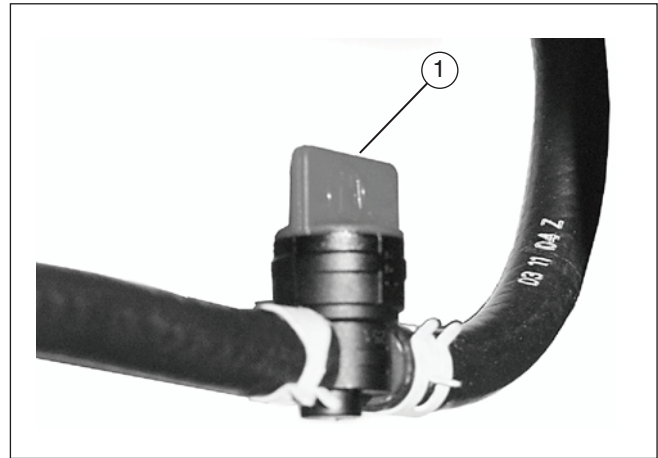

Figure 14

Transport the Unit

To transport the unit, follow the steps below.

1. Move the blade rotation control (1) to the DISENGAGE position (see **Figure 13**).
2. Raise the lift lever (5) to the highest position.
3. Move the throttle control (7) to a position between SLOW and FAST.
4. To go faster, move the shift lever (4) to a faster speed.

Operate with the Mower Housing

IMPORTANT: When you operate with the mower housing, always operate with the throttle control in the FAST position.

1. Start the engine.
2. Move the lift lever (5) to a height of cut position (see **Figure 13**). In high or thick grass, cut the grass in the highest position first and then lower the mower housing to a lower position.
3. Move the throttle control (7) to the SLOW position.
4. Slowly move the blade rotation control (1) to the ENGAGE position.
5. Push the clutch/brake pedal (2) completely forward.
6. Move the shift lever (4) to one of the speed settings.

NOTE: When you mow in heavy grass or mow with a bagger, put the shift lever in the slowest speed.

7. Slowly release the clutch/brake pedal.
8. Move the throttle control to the FAST position. If you need to go faster or slower, stop the unit and move the shift lever to another speed setting.

Operation

9. Make sure the level of cut is still correct. After you mow a short distance, look at the area that was cut. If the mower housing does not cut level, see “Level the Mower Housing”.

WARNING

For better control of the unit, select a safe speed.

Operate on Hills

WARNING

Do not ride up or down slopes that are too steep to back straight up. Never ride the unit across a slope.

1. Before you ride up or down a hill, move the shift lever (4) to the slowest speed (see **Figure 13**).
2. Do not stop or change speed settings on a hill. If you must stop, quickly push the clutch/brake pedal (2) forward and set the parking brake.
3. To start again, make sure the shift lever is in the slowest speed. Move the throttle control (7) to the SLOW position. Slowly release the pedal.
4. If you must stop or start on a hill, always have enough space for the unit to roll when you release the brake and engage the clutch.
5. Be very careful when you change directions on a hill. When on a slope or in a turn on a hill, move the throttle control to the SLOW position to help prevent an accident.

Use the Grass Bagger

WARNING

Do not ride up or down slopes that are too steep to back straight up. Never ride the unit across a slope.

To operate with the grass bagger, follow the steps below.

1. Start the engine.
2. Move the throttle control (7) to FAST position (see **Figure 13**).
3. Move the shift lever (4) to FIRST position. To fill the grass bag, always operate at the slowest speed.

4. If the height of the grass is more than 3-1/2 inches (9 cm), cut the grass with the mower housing in the highest position. Then, lower the mower housing and cut the grass again. You can also cut at 1/2 to 2/3 of the full cutting width of the mower housing.

Clear the Connector Tube and the Extension Tube

If the connector tube or the extension tube becomes filled with grass, clear as follows.

1. Move the blade rotation control (1) to the DISENGAGE position (see **Figure 13**).
2. Move the shift lever (4) to the neutral (N) position.
3. Engage the parking brake (6).
4. Stop the engine.
5. Remove the grass bagger (9) (see **Figure 8**).
6. Use a long stick to push any grass and debris from the connector tube or the extension tube (see **Figure 15**).
7. If the connector must be removed, see “Remove the Connector Tube”.

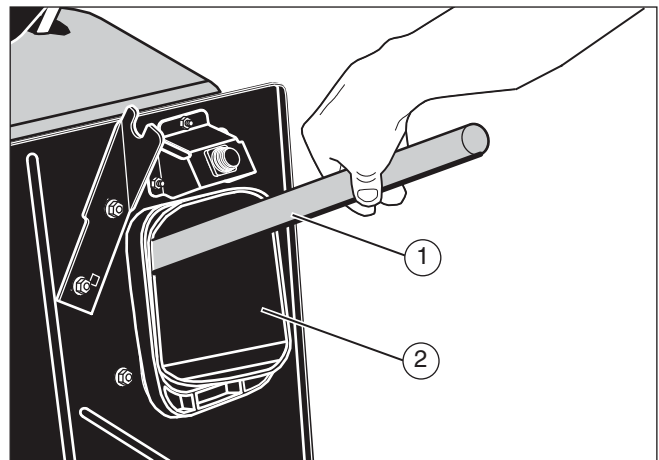

Figure 15

Empty the Grass Bagger

1. Move the blade rotation control (1) to the DISENGAGE position (see **Figure 13**).
2. Move the shift lever (4) to the neutral (N) position.
3. Engage the parking brake (6).
4. Raise the rear of the grass bag (see **Figure 16**).

Operation

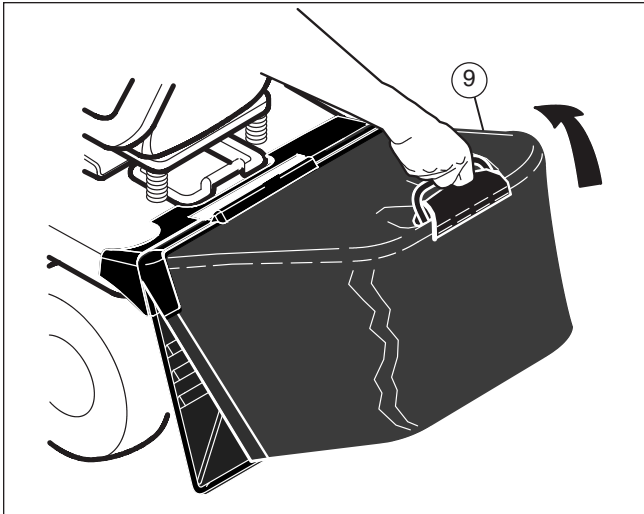

Figure 16

Before Starting the Engine

Check the Oil

NOTE: The engine was shipped from the factory filled with oil. Check the level of the oil. Add oil as needed. See the engine manufacturer's instructions for the type of petrol and oil to use.

1. Make sure the unit is level.

NOTE: Do not check the level of the oil while the engine runs.

2. Check the oil. Follow the procedure in the engine manufacturer's instructions.
3. If necessary, add oil until the oil reaches the FULL mark on the dipstick. The quantity of oil needed from ADD to FULL is shown on the dipstick. Do not add too much oil.

Add Petrol

WARNING

Always use a safety petrol container. Do not smoke when adding petrol to the fuel tank. Do not add petrol when you are inside an enclosure. Before you add petrol, stop the engine and let the engine cool for several minutes.

1. Fill the fuel tank to the FULL position with regular unleaded petrol (see Figure 17). Do not use premium unleaded petrol. Make sure the petrol is fresh and clean. Leaded petrol will increase deposits and shorten the life of the valves.
2. Some models have a fuel shut-off valve (1) located under the fuel tank (see Figure 14). If equipped, turn the fuel shut-off valve 1/4 turn to the OPEN position.

Start the Engine

WARNING

The electrical system has an operator presence system that includes a sensor switch for the seat. These components tell the electrical system if the operator is sitting on the seat. This system will stop the engine when the operator leaves the seat. For your protection, always make sure this system operates correctly.

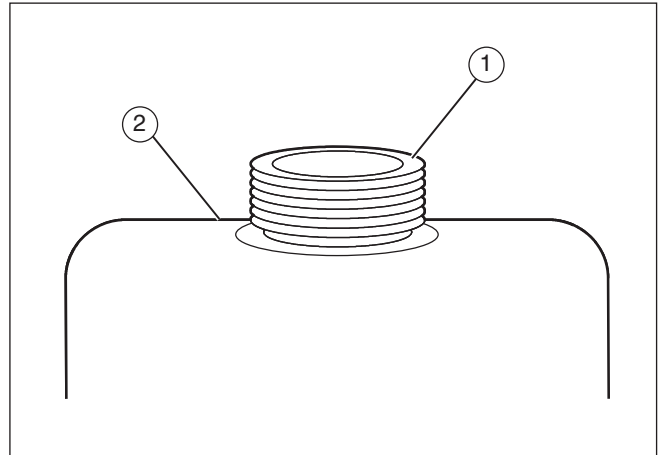

Figure 17

NOTE: The engine will not start unless you depress the clutch/brake pedal or engage the parking brake and move the blade rotation control to the DISENGAGE position.

1. Push the clutch/brake pedal (2) completely forward. Keep your foot on the pedal (see Figure 13).
2. Move the shift lever (4) to the neutral (N) position.
3. Make sure the blade rotation control (1) is in the DISENGAGE position.
4. Move the throttle control (7) completely forward to the CHOKE or FAST position. Some models have a separate choke knob. Pull the choke knob to the full CHOKE position.
5. Turn the ignition key to the START position.

NOTE: If the engine does not start after four or five tries, move the throttle control to the FAST position. Again try to start the engine. If the engine will not start, see the Troubleshooting Chart.

6. Slowly move the throttle control to the SLOW position.
7. To start a hot engine, move the throttle control to a position between FAST and SLOW.

Operation

Mowing and Bagging Tips

1. For a lawn to look better, check the cutting level of the mower housing. See “Level the Mower Housing”.
2. For the mower housing to cut level, make sure the tires have the correct amount of air pressure. The correct air pressure is shown on the side of the tires.
3. Every time you use the unit, check the blade. If the blade is bent or damaged, immediately replace the blade. Also, make sure the nut for the blade is tight.
4. Keep the blade(s) sharpened. Worn blades will cause the ends of the grass to turn brown.
5. If the grass is very high, cut two times to decrease the load on the engine. First cut with the mower housing in the highest position and then lower the mower housing for the second cut.
6. Operate the engine with the throttle in FAST position and the shift level in first or second gear.
7. For better cutting performance and a quality cut, mow with the shift lever in one of the slower speeds.
8. After each use, clean the bottom and top of the mower housing for better performance. Also, a clean mower housing will help prevent a fire.

Maintenance Chart

Frequency	Maintenance Required	Comments
Daily or before each use	Maintenance engine.	Refer to the Engine Owner's Manual.
	Examine blade(s).	Check for cracks, wear, and excessive damage.
	Remove debris from unit and moving parts.	
	Examine all rotating and sliding parts.	
	Check tire inflation.	Refer to the Maintenance section.
	Verify that the mower housing is level.	Refer to the Maintenance section.
	Examine V-belts.	Check for cracks, wear, and excessive damage.
	Check brake operation.	Refer to the Engine Owner's Manual.
After completion of first 5 hours	Change oil.	Refer to the Engine Owner's Manual.
After 25 hours	Maintenance engine.	Refer to the Engine Owner's Manual.
	Remove, examine, sharpen, and balance blade(s).	Refer to the Maintenance section.
	Check adjustments: a. Blade Rotation Control b. Brake c. Clutch d. Steering	Refer to the Maintenance section.
	Lubricate chassis and mower housing.	Refer to Where to Lubricate instructions.
	Check the muffler: a. Torque b. For wear or burn out c. Condition of spark arrester (if applicable)	Refer to the Maintenance section.
Before storage of 30 days or more	Prepare engine for storage.	Refer to the Engine Owner's Manual.
	Drain fuel system.	Refer to Warnings in Owner's Manual.
	Add fuel stabilizer.	Refer to the Engine Owner's Manual.
	Prepare battery for storage: a. Remove from unit. b. Fully charge. c. Move to cool dry place.	

Maintenance

General Recommendations

1. The owner's responsibility is to maintain this product. This will extend the life of the product and is also necessary to maintain warranty coverage.
2. Check the spark plug, drive brake, lubricate the unit, and clean the air filter once a year.
3. Check the fasteners. Make sure all fasteners are tight.
4. Follow the Maintenance section to keep the unit in good operating condition.

WARNING

Before you make an inspection, adjustment, or repair to the unit, disconnect the wire to the spark plug. Remove the wire from the spark plug to prevent the engine from starting by accident.

NOTE: Torque is measured in metric N-m (ft-lbs). This measurement describes how tight a nut or bolt must be. The torque is measured with a torque wrench.

Remove and Install the Connector Tube

For good bagging performance, the connector tube must be clean and free from grass and debris. Remove and clean the connector tube as follows.

Remove the Connector Tube

1. Move the blade rotation control (1) to the DISEN-GAGE position (see **Figure 13**).
2. Move the shift lever (4) to the neutral (N) position.
3. Engage the parking brake (6).
4. Stop the engine.
5. Move the lift lever (5) to the middle cutting position.
6. Disconnect the rubber strap (1) from the latch pin (2) on the connector tube (3) (see **Figures 18 and 19**).
7. Hold the handles (4). Remove the grass bag (5) (see **Figure 20**).
8. Pull the connector tube (3) through hole in rear plate (6) (see **Figure 21**).
9. Clean the connector tube (3) with soap and water.

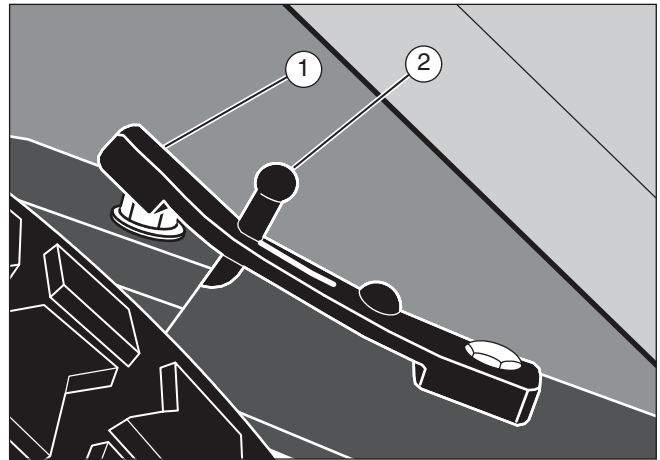

Figure 18

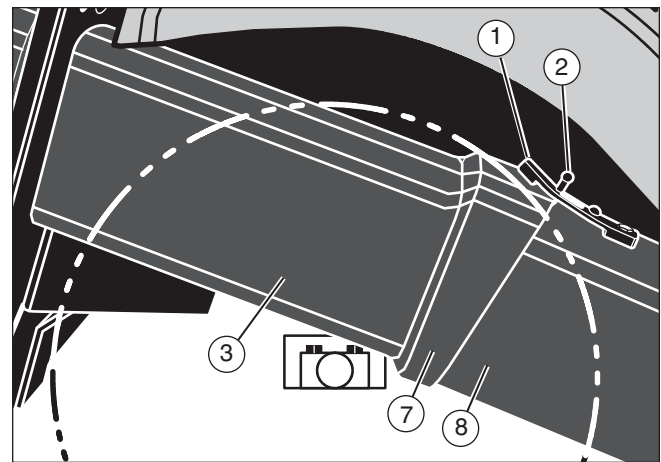

Figure 19

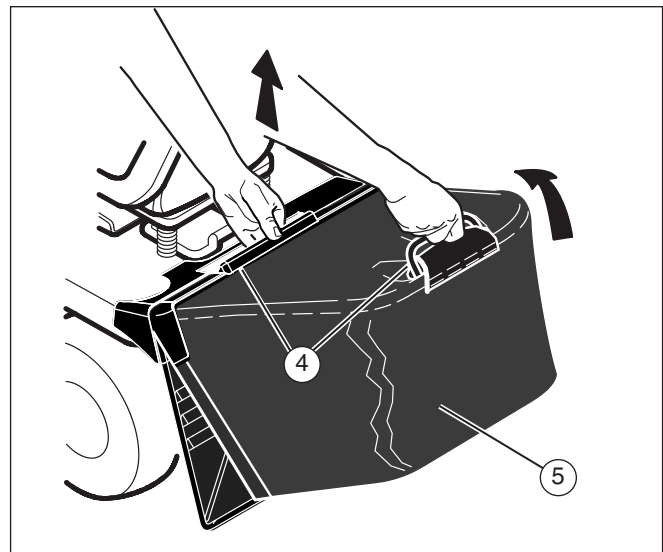

Figure 20

Maintenance

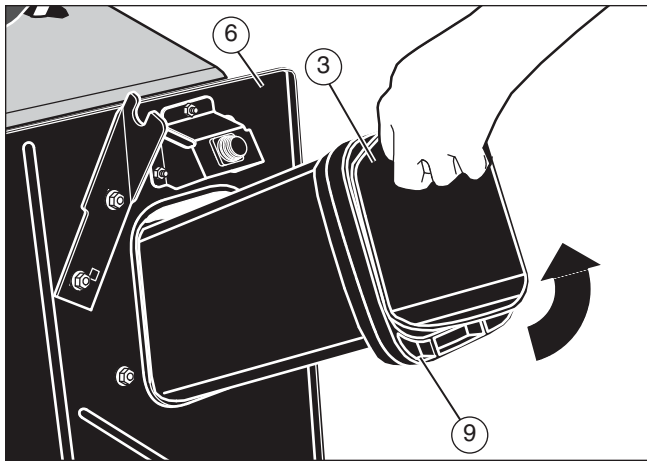

Figure 21

Install the Connector Tube

1. Slide the flange (7) end of the connector tube (3) through hole in rear plate (6) (see **Figures 19 and 21**).
2. Slide the flange end of the connector tube over the extension tube (8) (see **Figure 19**).
3. Attach the rubber strap (1) to the latch pin (2) on the connector tube (3) (see **Figures 18 and 19**).
4. Install the grass bag.

Inspect the Blade

WARNING

Before you inspect or remove the blade, disconnect the wire to the spark plug. If the blade hits an object, stop the engine. Check the unit for damage. The blade has sharp edges. When you hold the blade, use gloves or cloth material to protect your hands.

If you keep the blade (1) sharp and inspect the blade for damage, the blade will cut better and be more safe to operate (see **Figure 22**). Frequently check the blade for excessive wear, cracks, or other damage.

Frequently check the nut (3) that holds the blade. Keep the nut tight. If the blade hits an object, stop the engine. Disconnect the wire to the spark plug. See if the blade is bent or damaged. Check the blade adapter (5) for damage.

Before you operate the unit, replace damaged parts with original equipment parts. See the authorized service center in your area. Every three years, have an authorized service person inspect the blade or replace the old blade with an original equipment part.

Remove and Install the Blade

1. Remove the mower housing. See “Remove the Mower Housing.”
2. Use a piece of wood to keep the blade from rotating.
3. Remove the nut (3) that holds the blade (1) (see **Figure 22**).

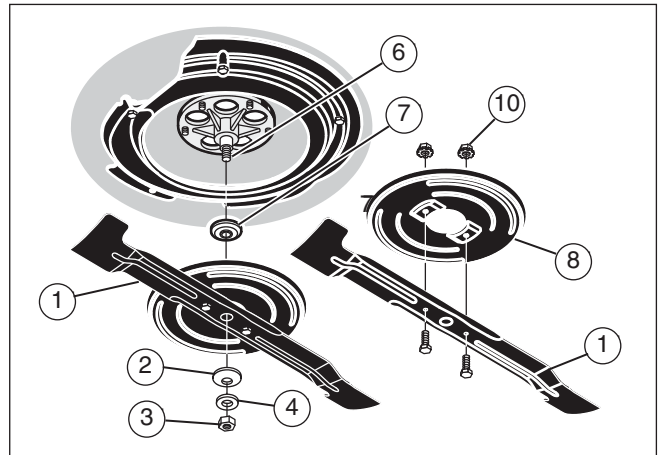

Figure 22

4. To remove the blade (1) from the air assist fan (8), remove fasteners (9) and (10).
5. Check the blade and blade adapter (5) according to the instructions for “Inspect the Blade”. Check the air assist fan for damage. Replace badly worn or damaged parts with original equipment parts. See an authorized service center in your area.
6. Clean the top and bottom of the mower housing. Clean the air assist fan. Remove all the grass and debris.
7. Assemble the blade and air assist fan with fasteners (9) and (10). Tighten the bolt that holds the blade to 6,8 N-m (5 ft-lbs).
8. Mount the blade and blade adapter on the mandrel (6).
9. Mount the blade so that the hi-lift edges (7) are up. If the blade is upside down, the blade will not cut correctly and can cause an accident.
10. Fasten the blade with the original washers and nut (3). Make sure the outside rim of the Belleville washer (2) is against the blade.

Maintenance

WARNING

Always keep the nut tight that holds the blade. A loose nut or blade can cause an accident.

11. Tighten the nut that holds the blade to 41,5 N-m (30 ft-lbs).
12. Install the mower housing. See "Remove the Mower Housing."

Adjust the Blade Rotation Control

WARNING

To prevent an injury, the blade rotation control must operate correctly.

In normal usage, the blade rotation control will not require an adjustment. However, if the cutting performance decreases or the quality of cut is poor, make the following changes.

1. When you mow, make sure the throttle control (7) is in the FAST position (see **Figure 13**).
2. Move the blade rotation control to the DISENGAGE position (1) (see **Figure 23**).
3. Stop the engine. Disconnect the wire from the spark plug.
4. Check the blade(s). Keep a sharp edge on the blade(s). A blade that is not sharp will cause the tips of the grass to become brown.
5. Disconnect the blade drive spring (2) from the blade control rod (1). Move the blade drive spring to the middle hole (see **Figure 24**). This will increase the tension on the mower drive belt.

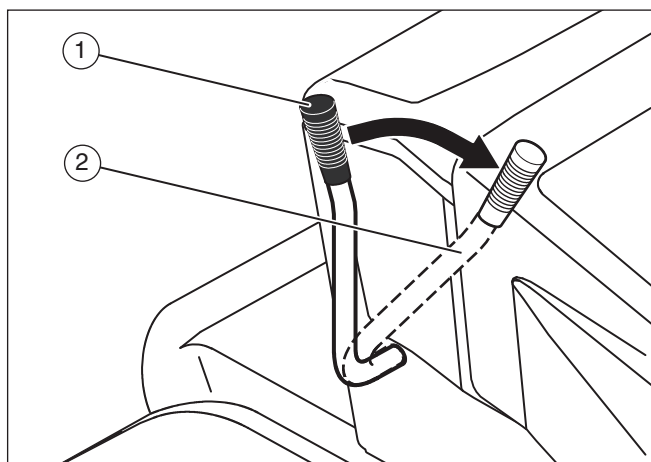

Figure 23

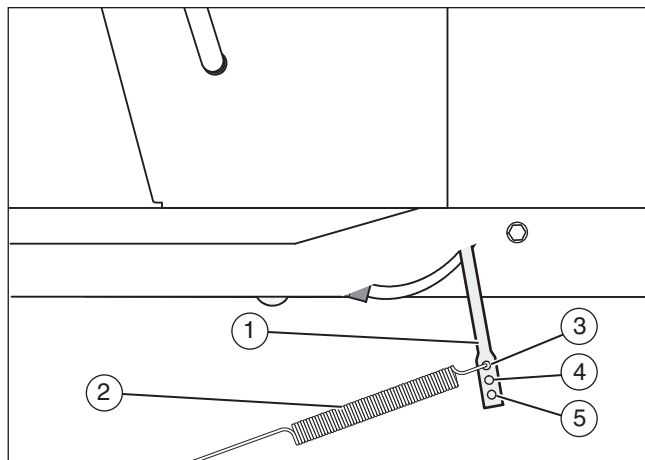

Figure 24

6. Attach the wire to the spark plug. Mow for a short distance and again check the quality of cut. If necessary, move the blade drive spring to the bottom hole.
7. Again check the quality of cut. If the quality of cut has not improved, replace the mower drive belt. See "Replace the Mower Drive Belt." If replacing the belt does not correct the problem, take the unit to an authorized service center.
8. Move the blade rotation control to the DISENGAGE position. Stop the engine.
9. Check the operation of the blade brake. Rotate the mandrel pulley with your hand. Make sure the brake pad is pressed tightly against the mandrel pulley (see **Figure 25**).

WARNING

If the brake pads do not press tightly against the pulleys, take the unit to an authorized service center.

10. Move the blade rotation control to the ENGAGE position (see **Figure 23**).
11. Check the pad for the blade brake (7) (see **Figure 25**). If the pad is excessively worn or damaged, replace the brake pad assembly. Correct replacement parts and assistance are available from an authorized service center.
12. Attach the wire to the spark plug. Mow for a short distance and again check the operation of the blade rotation control.

Maintenance

13. When you move the blade rotation control to the DISENGAGE position, all movement will stop within five seconds. If there is movement of the belt or the blade(s) continue to rotate, engage and disengage the blade rotation control five minutes to remove any excess rubber from a new mower drive belt. If you need assistance, take the unit to an authorized service center.
14. If you replace the mower drive belt, move the blade drive spring to the top hole (see **Figure 24**).

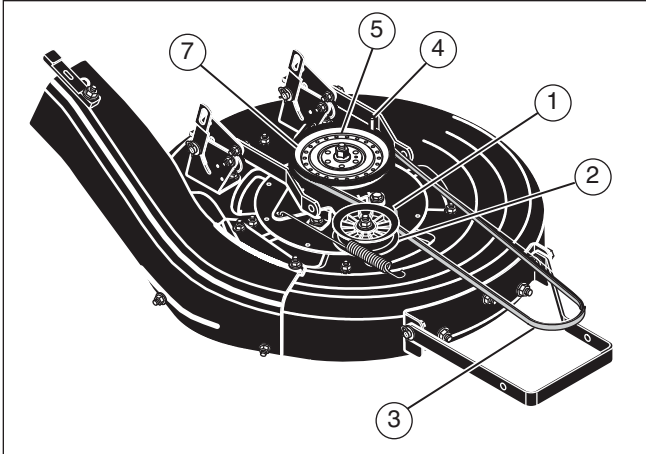

Figure 25

Adjust the Shift Lever

If the NEUTRAL position on the shift lever does not match neutral on the gearbox, adjust the shift lever as follows.

1. Stop the engine.
2. Disconnect the adjuster nut (2) from the shifter bracket (3) (see **Figure 26**).
3. Make sure the shift lever (4) is in the NEUTRAL position (see **Figure 13**).

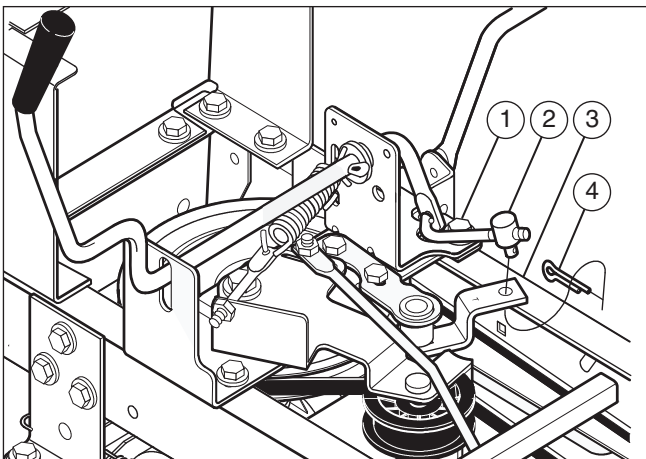

Figure 26

4. Push the unit forward. Make sure the gearbox is in neutral.
5. To align the adjuster nut (2) with the hole in the shifter bracket (3), turn the adjuster nut (2).
6. Connect the adjuster nut to the shifter bracket.
7. Make sure the NEUTRAL position on the shift lever matches neutral on the gearbox.

Check and Adjust the Clutch

If the motion drive belt is loose, the clutch will slip when; going up a hill, pulling a heavy load, or the unit will not move forward. Adjust the clutch as follows.

! WARNING

Before you make an inspection, adjustment, or repair to the unit, disconnect the wire to the spark plug. Remove the wire from the spark plug to prevent the engine from starting by accident.

1. Check the routing of the motion drive belt. Make sure the belt is installed correctly and is inside all the belt guides.
2. Remove the cotter pin (1), washer (2), and brake spring (3) from the adjustable nut (4) (see **Figure 27**).

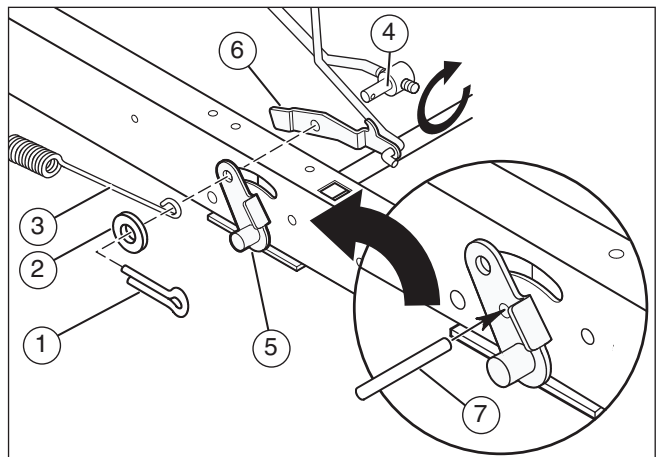

Figure 27

3. Disconnect the adjustable nut from the brake lever assembly (5) and the parking brake latch (6).
4. Align the hole in the brake lever with the hole in the frame. Hold the brake lever in place with a 6 mm pin or bolt (7).
5. Pull the clutch rod forward until tight. Turn the adjustable nut until the nut will fit through the hole in the brake lever.

Maintenance

6. Assemble the adjustable nut to the parking brake latch, brake lever and brake spring. Fasten with the washer (2) and cotter pin (1).
7. Remove the 6 mm pin or bolt.
8. If the belt still slips after the clutch has been adjusted, then the motion drive belt is worn or damaged and must be replaced. See "Replace the Motion Drive Belt."

Check and Adjust the Drive Brake

Completely push the clutch/brake pedal forward. Set the parking brake. Move the shift lever to the neutral (N) position. Push the unit. If the rear wheels rotate, adjust or replace the brake pads. Adjust the drive brake as follows.

1. The location of the drive brake (1) is on the right side of the gearbox (3) (see **Figure 28**).
2. Make sure the parking brake is set and the shift lever is in neutral (N). Turn the hex nut (2) in a clockwise direction until the rear wheels do not turn when the unit is pushed forward.
3. Release the parking brake and push the unit. If the unit does not roll, turn the hex nut in a counter-clockwise direction until the unit rolls.
4. Set the parking brake. Push the unit. If the rear wheels do not turn, the drive brake is correctly adjusted. Release the parking brake.

WARNING

If you cannot correctly adjust the drive brake, replace the brake pads. Correct replacement parts and assistance are available from an authorized service center.

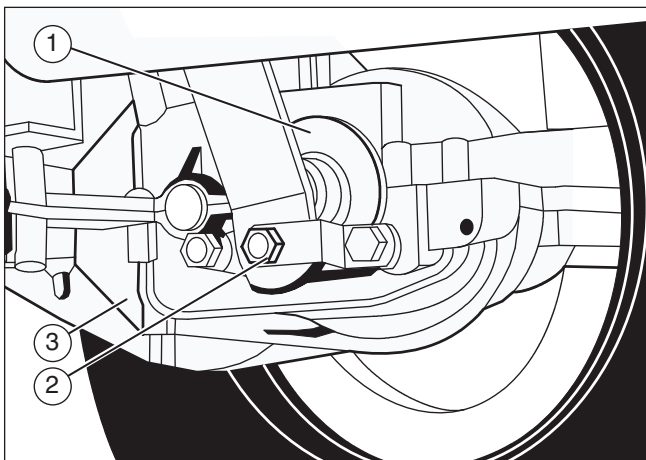

Figure 28

Remove the Battery

To charge or clean the battery (1), remove the battery from the unit as follows (see **Figure 12**).

WARNING

To prevent sparks, disconnect the black battery cable from the negative (-) terminal before you disconnect the red cable.

WARNING

The battery contains sulphuric acid which is harmful to the skin, eyes and clothing. If the acid gets on the body or clothing, wash with water.

1. Disconnect the black cable (8) from the negative (-) terminal.
2. Disconnect the red cable (5) from the positive (+) terminal (4).
3. Lift the battery tray (3) and the battery (1) out of the unit.

Charge the Battery

WARNING

When you charge the battery, do not smoke. Keep the battery away from any sparks. The fumes from the battery acid can cause an explosion.

1. Before you charge the battery (1), remove the battery (see **Figure 12**).
2. To charge the battery, use a 12 volt battery charger. Charge at a rate of 6 amps for 1 hour.
3. Install the battery.

WARNING

To prevent sparks, fasten the red cable to the positive (+) terminal before you connect the black cable.

4. Fasten the red cable (5) to the positive (+) terminal (4) with the fasteners as shown.
5. Fasten the black cable (8) to the negative (-) terminal with the fasteners as shown.

Maintenance

Level the Mower Housing

If the mower housing is level, the blade will cut easier and the lawn will look better.

WARNING

Before you make an inspection, adjustment, or repair to the unit, disconnect the wire to the spark plug. Remove the spark plug wire to prevent the engine from starting by accident.

1. Make sure the unit is on a hard flat surface.
2. Check the air pressure in the tires. If the air pressure is incorrect, the mower housing will not cut level. The correct air pressure is shown on the side of the tires.
3. Move the lift lever to the lowest position (see Figure 28).

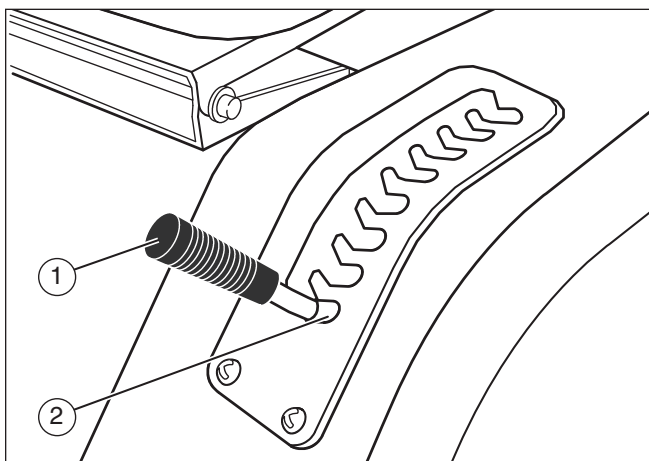

Figure 28

WARNING

The lift lever (3) is spring loaded. Make sure the lift lever (3) is locked in the lowest position (2).

4. Loosen the left and right adjuster knobs (1) (see Figure 29). Push down on each side of the mower housing. Make sure both sides of the mower housing are setting on a flat surface. Also, make sure the lift links are loose and can easily move up or down.
5. Push down on the adjuster knobs and the lift links. Tighten the left and right adjuster knobs. Make sure the adjuster knobs are tight. If necessary, use a wrench to tighten the adjuster knobs. Tighten to 13,5 N-m (10 ft-lbs).
6. Raise the lift lever (1) (see Figure 28).
7. Mow for a short distance. If the height of cut is not level, repeat the above steps.

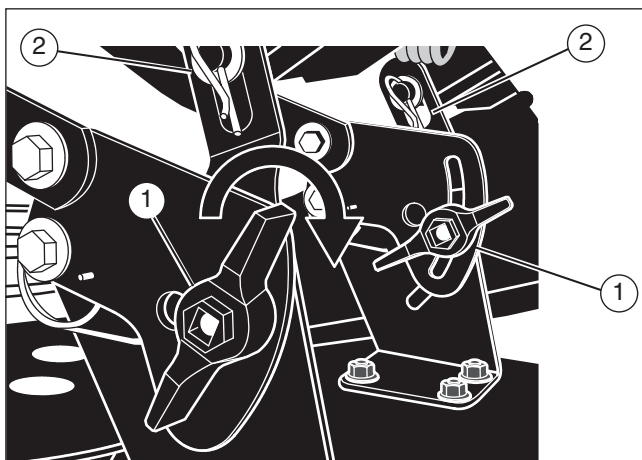

Figure 29

Where to Lubricate



Models with grease fittings: Lubricate with grease gun (see Figure 30).

Apply grease with a brush to the areas shown.

Lubricate the areas shown with engine oil.

NOTE: Apply grease to the steering gear assembly.

CAUTION: If the unit is operated in dry areas that have sand, use a dry graphite spray to lubricate the unit.

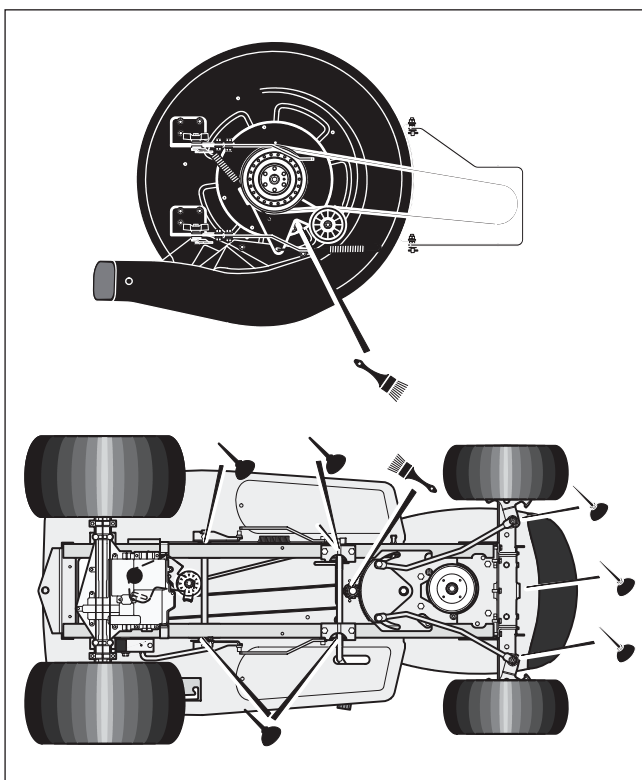

Figure 30

Maintenance

Check the Tires

Check the air pressure in the tires. Tires with too much air pressure will cause the unit to ride rough. Also, the wrong air pressure will keep the mower housing from cutting level. The correct air pressure is: Front Tires 0,97 BAR (14 PSI), Rear Tires 0,69 BAR (10 PSI).

Replace the Motion Drive Belt

1. Remove the mower housing. See the instructions to "Remove the Mower Housing."
2. Completely push the pedal forward and engage the parking brake.
3. Remove the idler pulley (1) (see **Figure 32**).
4. To access the belt guides (1), remove the battery and battery tray (see **Figure 33**). See "Remove the Battery."
5. Loosen the belt guides (1) at the drive pulley (2).
6. Remove the motion drive belt (3) from the drive pulley (4) (see **Figure 32**).

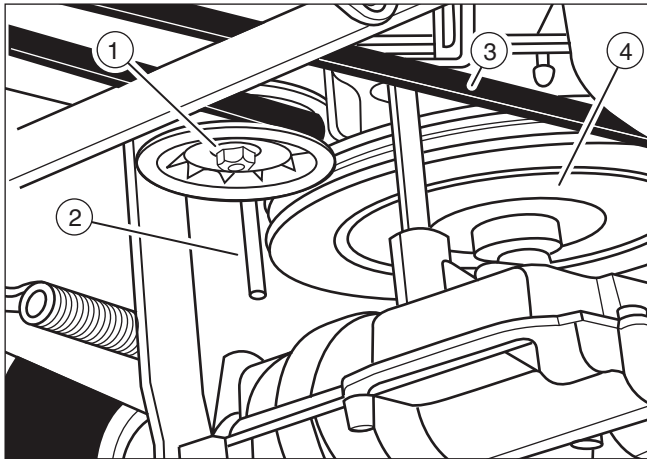

Figure 32

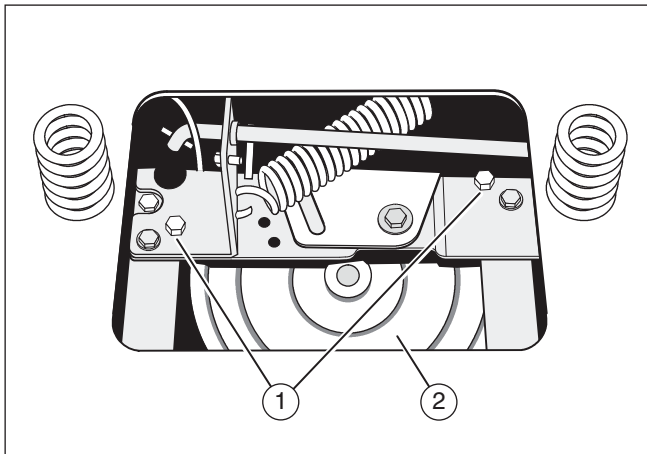

Figure 33

7. Remove the adjuster nut (2) from the shifter bracket (3). Pull the motion drive belt over the shifter bracket (3) (see **Figure 26**).
8. To remove the motion drive belt (1) from the stack pulley (2), pull the front end of the belt under the stack pulley and then back between the stack pulley and the steering plate (3) (see **Figure 34**).

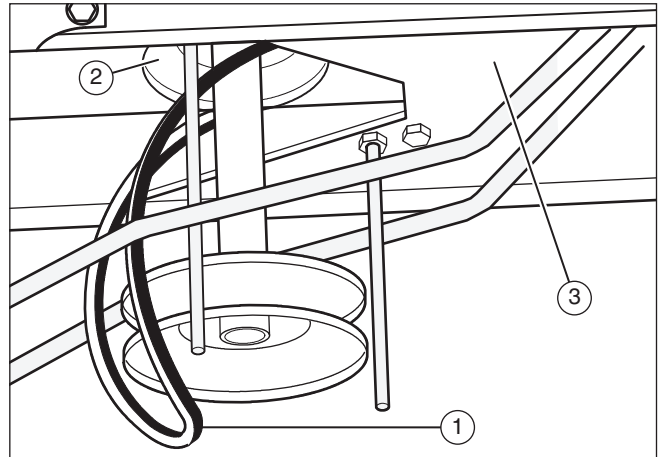

Figure 34

9. Remove the access panel (1) (see **Figure 35**).
10. Remove the two screws (4) that attach the steering shaft assembly. Raise the steering wheel and steering shaft assembly. Pull the motion drive belt (3) under the steering shaft assembly.
11. Remove the motion drive belt. A correct replacement part or assistance is available from an authorized service center in your area.

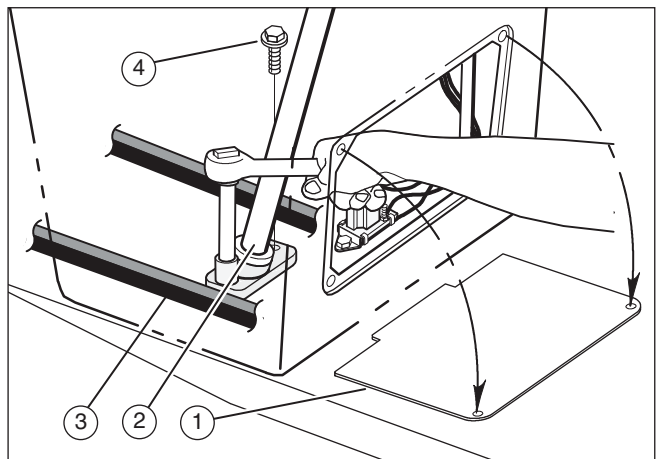

Figure 35

Maintenance

12. To install the motion drive belt, reverse the above steps.
13. Check the routing of the motion drive belt (1) (see **Figure 26**). Make sure the motion drive belt is installed correctly on the idler pulley (2). Make sure the steering shaft assembly (3) is inside the motion drive belt.

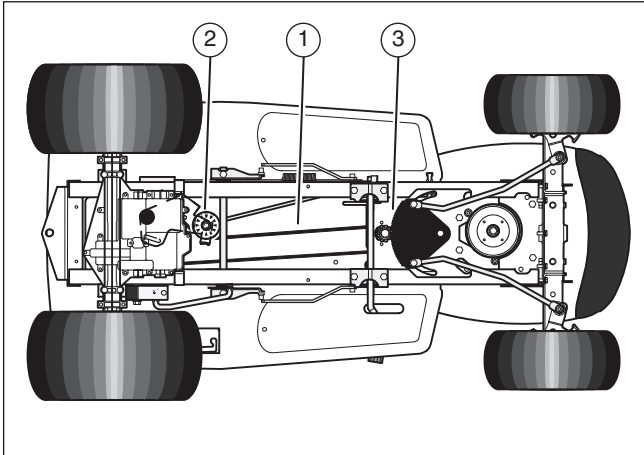

Figure 36

Replace the Mower Drive Belt

1. Remove the mower housing. See the instructions on "How To Remove The Mower Housing".
2. Pull the belt retainer (1) away from the idler pulley (2) and remove the mower drive belt (3) (see **Figure 34**).
3. Pull the belt guide (4) and the brake assembly (7) away from the mandrel pulley (5) and remove the mower drive belt (3) (see **Figure 25**). A correct replacement part or assistance is available from an authorized service center in your area.
4. To install the mower drive belt, reverse the above steps.
5. Before you mow, check the blade rotation control. See the instructions to "Adjust The Blade Rotation Control".

Remove the Mower Housing

1. Move the blade rotation control (1) to the DIS-ENGAGE position (see **Figure 37**).
2. Move the lift lever (2) to the lowest position.

WARNING

The lift lever (3) is spring loaded. Make sure the lift lever (3) is locked in the lowest position (2).

3. Remove the hair pins and the washers from the adjuster arms (3). See illustrations "C" and "D".
4. Remove the hair pins and washers from the suspension links (4). See illustrations "A" and "B".
5. Disconnect the extension spring (5) from the blade control rod (6). See illustration "E".
6. Disconnect the front hanger (9) from the axle support. See illustration "F".
7. Remove the mower drive belt (7) from the stack pulley (8). See illustration "G".
8. Disconnect the rubber strap (1) from the connector tube (3). Slide the connector tube off the extension tube (8) (see **Figure 19**).
9. Pull the mower housing away from the right side of the unit.
10. To install the mower housing, reverse the above steps.

Maintenance

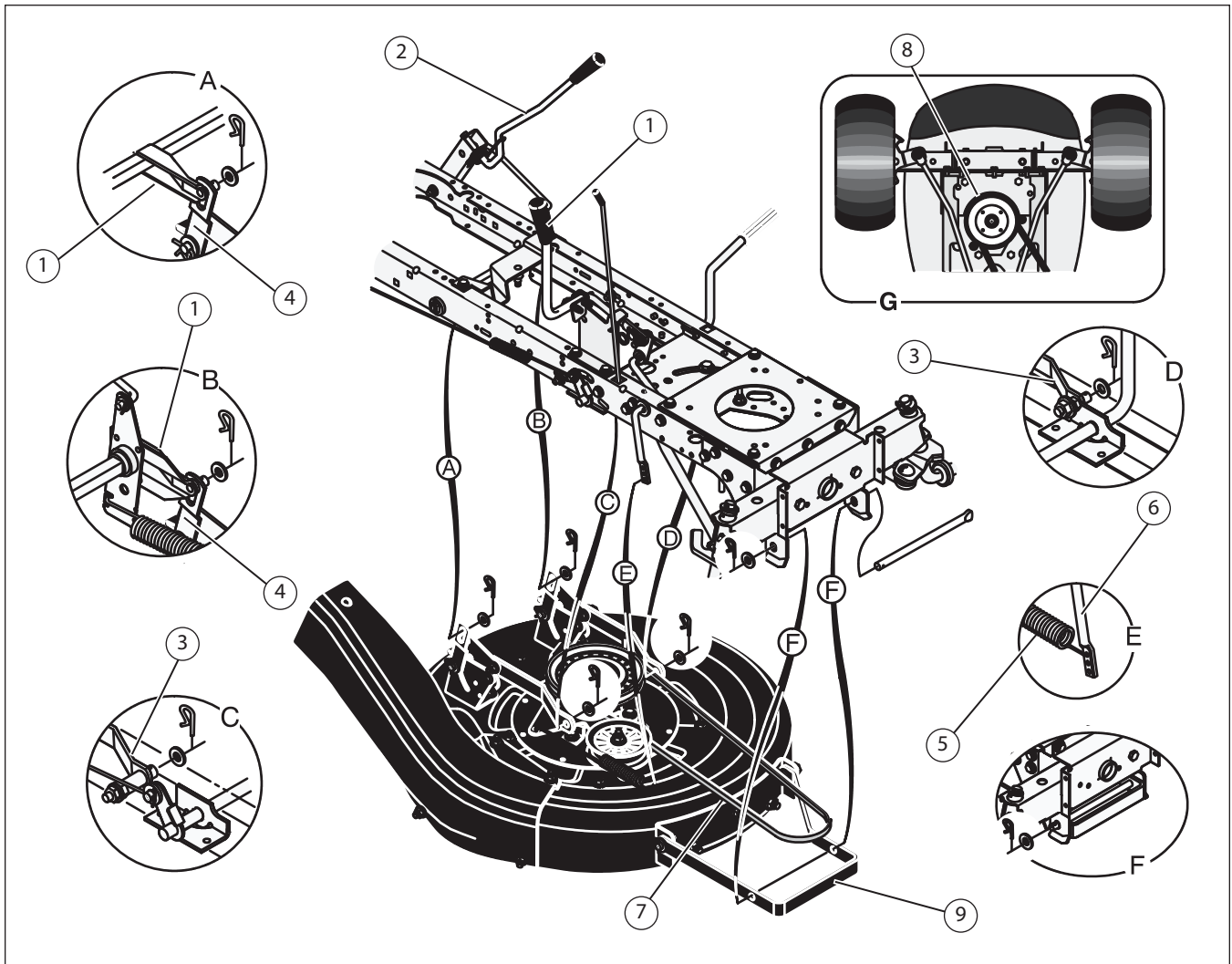

Figure 37

Replace the Fuse

If the fuse is blown, the engine will not start.

Remove the fuse and replace with a 15 amp automotive fuse.

Storage (over 30 days)

At the end of each year, prepare the unit for storage as follows.

1. Drain the fuel from the carburetor and the fuel tank. Change the engine oil. See the engine manufacturer's instructions.
2. Clean the entire unit.
3. Charge the battery.

Maintenance

Order Replacement Parts

The replacement parts are shown either on the back pages of this Instruction Book or in a separate Parts List Book.

Use only manufacturer's authorized or approved replacement parts. Do not use attachments or accessories not specifically recommended for this unit. In order to obtain proper replacement parts you must supply the model number of your mower (see nameplate).

Replacement parts, except for the engine, transmission, transaxle or differential, are available from the store where the mower was purchased or a service shop recommended by the store.

Warranty service is available only through Authorized Service Dealers. Locate your nearest dealer in our locator map at www.murray.com.

Replacement parts for the engine, transaxle, or transmission, are available from the manufacturer's authorized service center found in the commercial pages of the telephone directory. Also, see the individual engine or transmission warranties to order replacement parts.

When ordering the following information is required:

- (1) Model Number
- (2) Serial Number
- (3) Part Number
- (4) Quantity

Troubleshooting Chart

Problem	Solution
The engine will not start.	1. Follow the steps, "Start the Engine" in this book.
	2. Electric-Start Models: Clean the battery terminals. Tighten the cables.
	3. Drain the fuel tank. Clean the fuel line. Replace the fuel filter.
	4. Remove the spark plug(s). Move the throttle to the SLOW position. Turn the ignition key to the ON position. Try to start the engine several times. Install the spark plug.
	5. Replace the spark plug.
	6. Adjust the carburetor.
The engine will not turn over.	1. Follow the steps, "Start the Engine" in this book.
	2. Electric-Start Models: Check the level of the acid in the battery. If needed, add water. Charge the battery.
	3. Replace the fuse.
	4. Check the wiring harness for damage or a loose connection. Repair the damaged wire.
	5. Electric-Start Models: replace the solenoid. Recoil-Start Models: replace the module.
The engine is difficult to start.	1. Adjust the carburetor.
	2. Replace the spark plug.
	3. Replace the fuel filter.
The engine does not run smooth or has a loss of power.	1. Check the oil.
	2. Clean the air filter.
	3. Clean the air screen.
	4. Replace the spark plug.
	5. The engine is working too hard. Use a lower gear.
	6. Adjust the carburetor.
	7. Replace the fuel filter.
The engine does not run smooth at fast speed.	1. Replace the spark plug.
	2. Adjust the throttle control.
	3. Clean the air filter.
	4. Replace the fuel filter.
The engine stops when the blades are engaged.	1. To activate the seat sensor, always sit in the middle of the seat.
	2. Check the wiring harness for damage or a loose connection. Repair the damaged wire.
On slopes, the engine stops.	1. Mow up and down slopes. Never mow across a slope.
	2. To activate the seat sensor, always sit in the middle of the seat.

Troubleshooting Chart

Problem	Solution
The engine will not idle.	1. Replace the spark plug.
	2. Clean the air filter.
	3. Adjust the carburetor.
	4. Adjust the throttle control.
	5. Drain the fuel tank. Clean the fuel line. Replace the fuel filter.
A hot engine causes a decrease in power.	1. Clean the air screen.
	2. Check the oil.
	3. Adjust the carburetor.
	4. Replace the fuel filter.
Excessive vibration.	1. Replace the blade.
	2. Check for loose engine bolts.
	3. Decrease the air pressure in the tires.
	4. Adjust the carburetor.
	5. Check for a damaged belt or damaged pulley. Replace the damaged parts.
The grass does not discharge correctly.	1. Stop the engine. Clean the mower housing.
	2. Raise the height of cut.
	3. Replace or sharpen the blade(s).
	4. Move the shift lever to a lower speed.
	5. Move the throttle control to the FAST position.
	6. Replace the spring for the blade idler.
	7. Clean the extension tube and the connector tube (applies only to model with rear discharge grass bag).
The mower housing does not cut level.	1. Check the air pressure in the tires.
	2. Adjust the level of the mower housing.
	3. Check the front axle. If the front axle does not freely pivot, loosen the axle bolt(s).
The mower blades will not rotate.	1. Check the mower drive belt. Make sure the belt is installed correctly.
	2. Replace the mower drive belt.
The unit will not move when the clutch is engaged.	1. Check the motion drive belt. Make sure the belt is installed correctly.
	2. Adjust the clutch.
	3. Replace the motion drive belt.
The unit moves slower or stops when the clutch is engaged.	1. Adjust the clutch.
	2. Replace the motion drive belt.

Troubleshooting Chart

Problem	Solution
When the clutch/brake pedal is released, belt noise can be heard.	1. Temporary belt noise does not change the operation of the unit. If belt noise is continuous, check the routing of the belt. Make sure the belt is inside all belt guides.
	2. If the noise is continuous, adjust the clutch.
The rear wheels spin over uneven terrain.	1. Check the front axle. If the front axle does not freely pivot, loosen the axle bolt(s).
The transaxle is difficult to shift between gears with the engine running and the clutch depressed.	1. Check the clutch adjustment to make sure the belt stops when the clutch pedal is depressed with the transaxle in (N) neutral.
	2. Check the belt guides around the transaxle drive pulley. Make sure the belt guides do not touch the pulley.

Notes

HAYTER
MAKERS OF THE FINEST MOWERS

BRIGGSandSTRATTON Yard Power Products Group
Copyright © 2008 Briggs & Stratton Corporation
Milwaukee, WI USA. All Rights Reserved

